

Continuous Glycol System

(Automatic City Water Backup)



Model CGS1-T



FUNCTION

Provides automatic city water back-up of your Haskris chiller through a heat exchanger and pumping system that isolates the emergency water source to prevent contamination and/or loss of fluid in the chiller glycol circuit.

TECHNICAL DATA

Cooling Capacity	Supports Haskris OPC1, OPC2 or OPC3 Chiller		
Water Pump Capacity	5.5 GPM (20.8 LPM)		
Pump Motor HP	3/4		
Power Requirements	230V-1Ø-60Hz 8.4 FLA	230V-3Ø-60Hz 3.3 FLA	460V-3Ø-60Hz 1.6 FLA
Dimensions (W x D x H)	32.75 x 13 x 32.5 in. 83 x 33 x 82 cm.		
Shipping Weight	230 Lbs. (104 Kg)		

EMERGENCY BACKUP WATER REQUIREMENTS FOR CGS1

Temperature

- Building water temperature must be a minimum 10°F colder than the supply temperature to your equipment.
(Emergency Backup Water = any source of cold water, including tap water or in-house chilled water.)

Pressure

- Inlet Pressure: Max. 100 psi
- Recommended Pressure Differential (across building water connections): 25 psi to 40 psi
Caution: Be sure to check back-pressure on the outlet side. A high inlet pressure alone will not ensure adequate flow.

DIMENSIONAL DATA

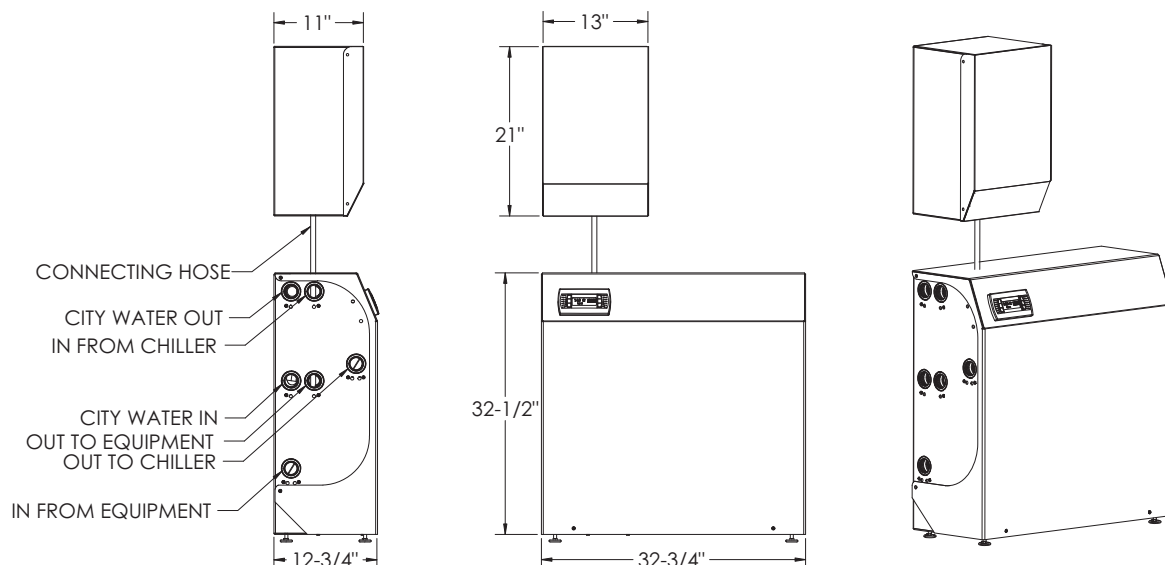

CGS1T-0111